

CUST. MODEL:	REF.
CUST. P/N	DWG FILE:

RoHS Compliance

Current Rating:
3 Amps
Voltage Rating:
250V AC R.M.S.
Insulator resistance:
1000 Megohms Min.
Dielectric withstanding:
DC 1000V for 1 minute
Contact resistance:
30miliohms Megohms Max.
Operating Temperature:
-55 ~ +105 °C
Contact Material:
Brass
Insulator Material:
PBT(UL94V-0)

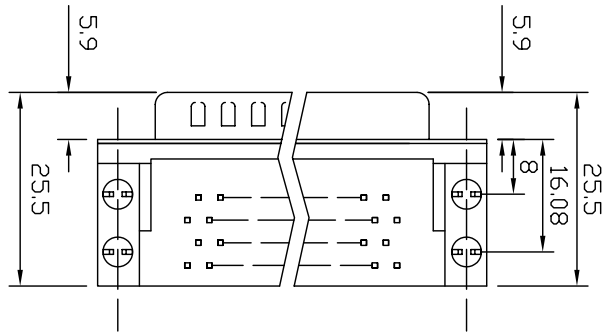
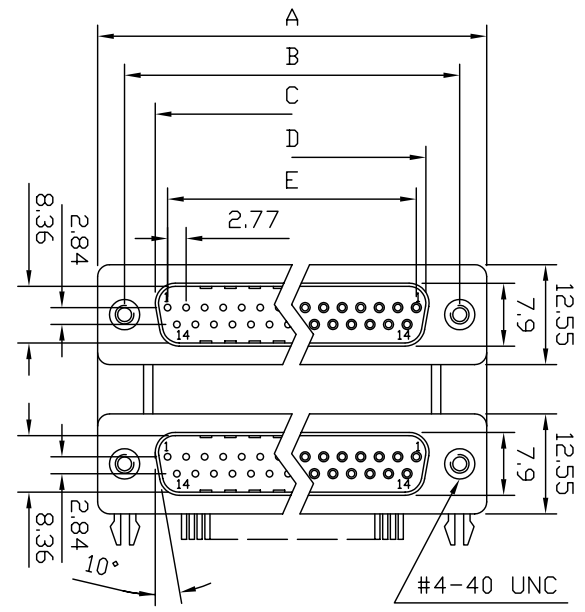

DESCRIPTION CONTROL			
REV.	DESC.	DATE	APP.

Dimension of "F"	
<1>	15.88
<2>	19.05
<3>	22.86

Positions	A	B	C	D	E
9	30.81	24.99	16.92	16.33	11.08
15	39.14	33.32	25.50	24.66	19.39
25	53.04	47.04	38.96	38.38	33.24
37	69.32	63.50	55.42	54.84	49.86

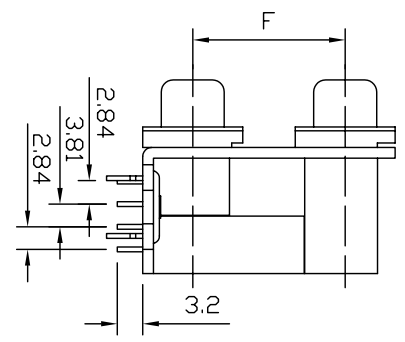

DS007-□□□□□□□□

No. OF PINS: 09,15,25,37	Flange Mounting Option: 0: 3.05mm clear hole 1: #4-40 threaded hole 2: #4-40 threaded hole with #4-40 unc screwlock installed 3: #4-40 threaded hole with #4-40 unc screwlock bulk-packed 4: M3 threaded hole 5: M3 threaded hole with M3 screwlock installed 6: M2.6 threaded hole 7: M2.6 threaded hole with M2.6 screwlock installed
Contact type(Top): A:09P,B:09S C:15P,D:15S E:25P,F:25S G:37P,H:37S I:HD15P,J:HD15S	
Contact type(Bottom): X:None I:HD15P,J:HD15S A:09P,B:09S K:09P*09P C:15P,D:15S L:09P*09S E:25P,F:25S M:09P*HD15S G:37P,H:37S N:Earphone Jack*3	Contact: 1:Gold flash and Tinned Tail 2:15u" Gold on contact 3:30u" Gold on contact 4:Selective Gold (Full Gold)
Position of clinch nut: 1:L-Shape support 2:Dual arrowhead boardlock 3:Quad arrowhead boardlock	Dimension: 1:F=15.88mm 2:F=19.05mm 3:F=22.86mm

UNLESS OTHERWISE SPECIFIED SURFACE FINISH ALL OVER TOLERANCES mm	DRAW:	DATE:	TITLE: D-Sub Conn. Dual Port Type
	CHUBBY	01/10/07	
METRIC .X = ±0.38 .XX = ±0.25	CHECK:	APPROVE:	MODEL CODE: DS007-XXXXXX
	KEVIN	TONY	

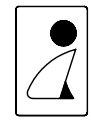

誠州電子有限公司
Sincere State Electronics Co.,Ltd.

NO	DESCRIPTION	QTY
----	-------------	-----